



Michael R. **COKER** Company

3111 Canton Street, Suite 140
Dallas, TX 75208
214.827.8100 (TX) 214.827.8102 (FL)
www.cokercompany.com

MAULDIN ARCHITECTS
MAULDIN ARCHITECTS
210-313-3197
WWW.MAULDINARCHITECTS.COM
INFO@MAULDINARCHITECTS.COM

WINTERBERRY DEVELOPMENT, LLC
2727 LBJ FREEWAY, STE. 1020
DALLAS, TEXAS 75234

6343 LAKE JUNE ROAD
DALLAS, TEXAS 75217

Issue/Revisions

No.	Date	Description
N1	022416	REVISION

Seal

Drawing Title

LANDSCAPE
PLAN

Issue Date: 022416
Coker Co Project: 21521
Reviewed By: MRC
Drawn By: ecs

Drawing Number

LPI

Filename: JOOMA-LAKE JUNE

This drawing is based on Mauldin Architects' Site Plan. The reproduction, copying, or use of this drawing without the written consent of Michael R. Coker Company is prohibited and any infringement will be subject to legal action. © Copyright 2016-2017 Michael R. Coker Company

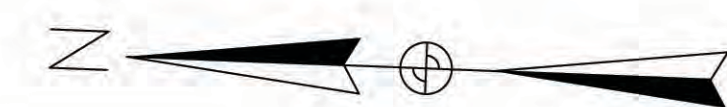
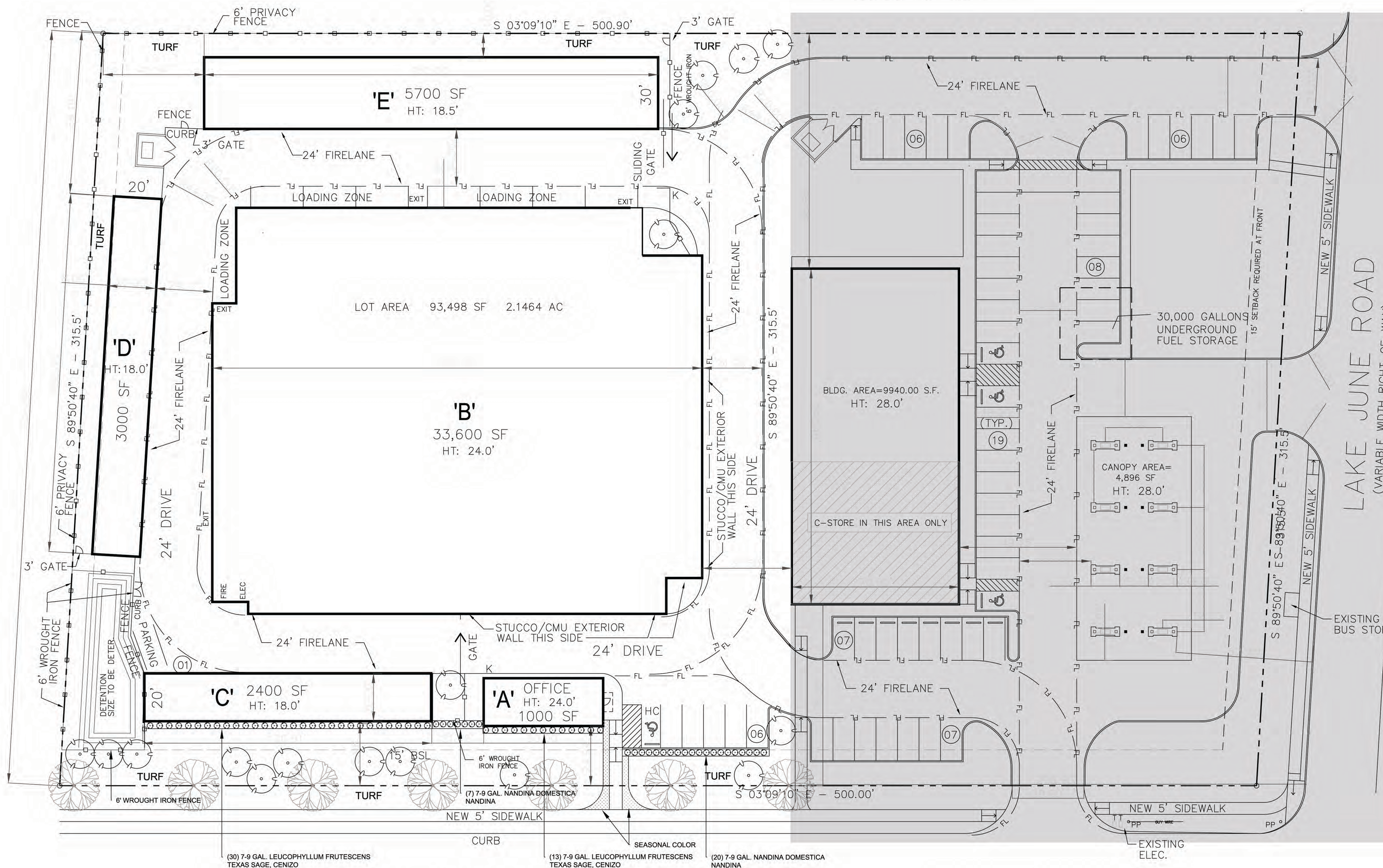

1 STORAGE LANDSCAPE PLAN
SCALE: 1" = 20'-0"



Storage Landscape Plan Notes:

Site Trees Required = 24
Site Trees Provided - 17

Street Trees Required = 7
Street Trees Provided = 7

*Street trees count as site trees if located on the subject property

Seed Bermuda in all turf areas
(27) 7-9 Gal. Nandina Domestica (Nandina) 3' OC
(43) 7-9 Gal. Leucophyllum frutescens (Texas Sage) 4' OC
Seasonal Color Plantings TBD

-  (7) 3" CAL. PECAN
-  (17) 2" CAL. RED BUD

AREA IN GRAY NOT
PART OF SUP

GUARD STREET
(100' RIGHT-OF-WAY)

LAKE JUNE ROAD
(VARIABLE WIDTH RIGHT-OF-WAY)